

netatmo  
BY  
STARCK®

3

Installing your first thermostat



*You can watch this installation at:*  
<http://netatmo.com/video3>

Warning

In the box

## Warning!

- Read these instructions carefully before starting the installation.
- The Netatmo Thermostat must be installed according to applicable standards.
- Before any intervention, make sure power is turned off.

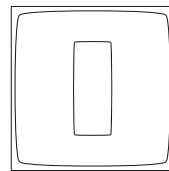
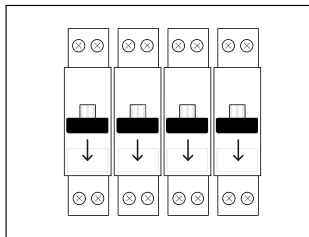
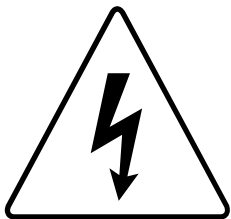

Thermostat

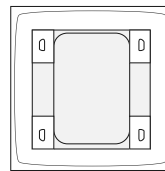

Mobile stand

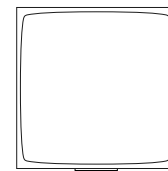

Relay

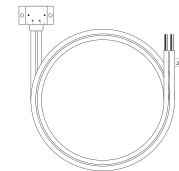

Boiler adapter



(Mounting Plate)\*

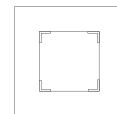

(Trim plate)\*

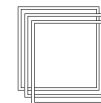

Color Adhesives

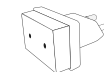

(Mains adapter)\*



Tape



3 AAA batteries



4 screws  
4 screw anchors

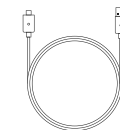

1 USB cable

*\* not used in this setup*

## Identify

Open the boiler door using the manual, if necessary.

Find your former thermostat's relay. Follow its wires to identify to which boiler terminals they are connected.

Take a picture of the wiring.

*Note* : Some thermostats are connected to different terminals from those on the diagram's list (for example, eBus, EMS...). In this case, you will have to identify the right thermostat terminals, labeled LS-LR, TA, or COM-NO.

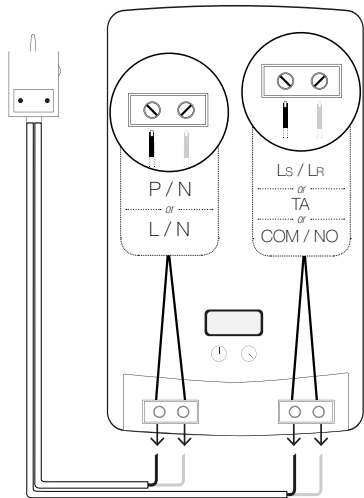

220V Power supply terminals  
Usually blue and brown wires

Thermostat terminal  
Usually black or grey wires

## Replace

Disconnect your former thermostat's relay.

Connect the wires of the **boiler adapter** in place of the former thermostat's relay, as shown on the diagram.

Our forum can help you identify where to plug the wires in, at [forum.netatmo.com](http://forum.netatmo.com).

In doubt, please send a picture of your wiring to: [photo@netatmo.com](mailto:photo@netatmo.com) and our support team will help you identify the right terminals.

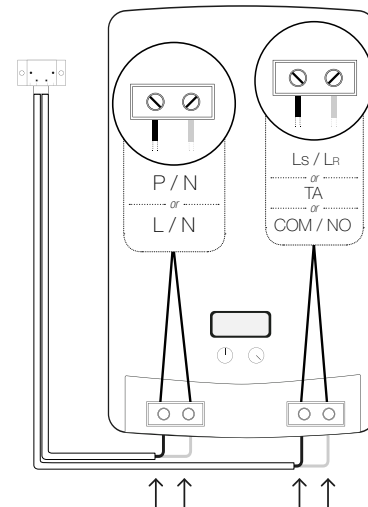

220V Power supply terminals  
Blue and brown wires

Thermostat terminal  
Black and grey wires  
No polarity

## Setting the relay

The **boiler adapter** should be placed as far as possible from metallic items (wiring, pipes, electrical grid...).

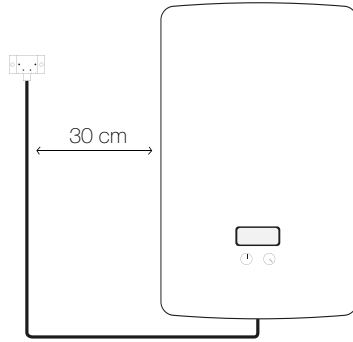

The **boiler adapter** can be affixed to the wall with the double-sided tape or the screws provided.

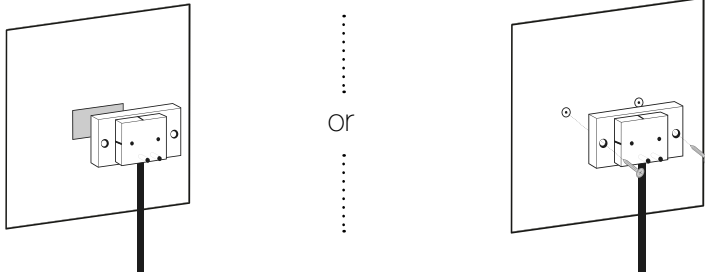

## Testing the relay

① Connect the **relay** into the **boiler adapter**.

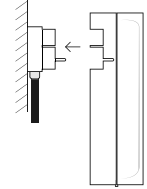

② Switch the power supply back on.

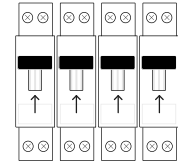

③ The **relay** will blink blue.

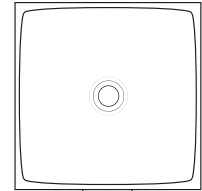

*Note : If the **relay** does not blink after turning the power back on, it is not power supplied. Please check how the blue and brown wires are wired. Do not forget to switch off the power supply before any intervention.*

## Testing the relay

①

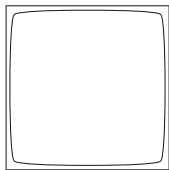

Push the **relay** button.

②

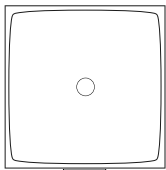

The **relay** will light up blue and switch on the boiler.

③

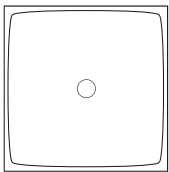

Push the **relay** button again.

④

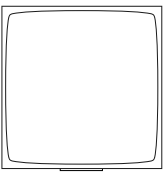

The **relay** light will turn off to indicate the boiler is off.

*Note: If the boiler doesn't switch on when the blue light is on, the **relay** is incorrectly wired to the boiler. In this case, check where the grey and black wires are connected. In doubt, please read in your boiler's instructions manual [the «room thermostat» section].*

## Thermostat

①

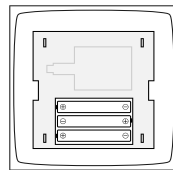

Insert the batteries into the **Thermostat**.

②

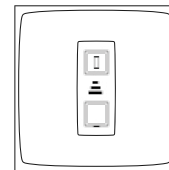

The **Thermostat** will display the start screen and search for the **relay**.



Desired temperature

Measured temperature

OR



If the **Thermostat** has found the **relay**, it will display the setpoint and the room temperatures.

If the **Thermostat** hasn't found the **relay**, it will display the «!» symbol. In this case, move the **relay** closer to the **Thermostat** and wait until the «!» symbol disappears.

## Customisation

- ① You can choose to customise your **Thermostat** by using one of the **colour adhesives**.

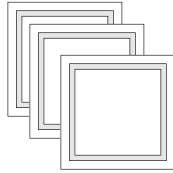

- ② Take off the outer frame of the **adhesive**.

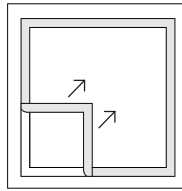

- ③ Stick it on the back of your **Thermostat**.

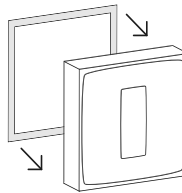

## Location

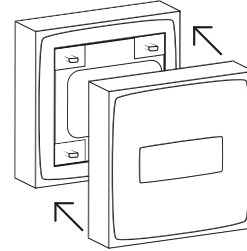

Clip the **Thermostat** on its **mobile stand** and place it on a shelf in the living room.

.....  
Or  
.....

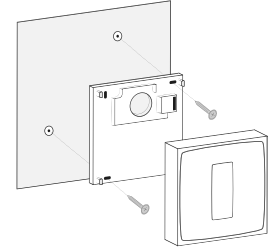

Set the **Thermostat** on the **mounting plate**.

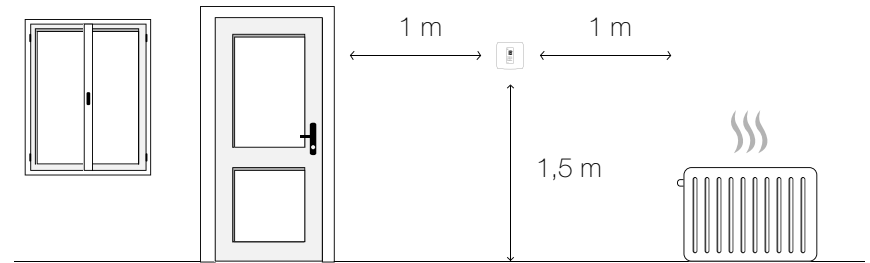

More than 1m from the openings

A 1,5 m high

Away from any cold or heat source

Test

App

①

Tap the top of the **Thermostat** until the screen shows « MAX ».

The **Thermostat** will switch on the boiler.

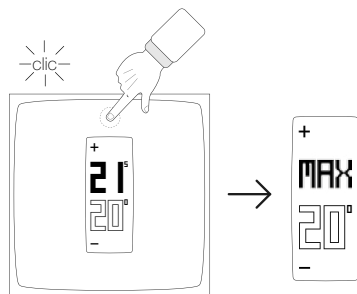

②

Tap the bottom of the **Thermostat** until it displays « OFF ».

The **Thermostat** will switch off the boiler.

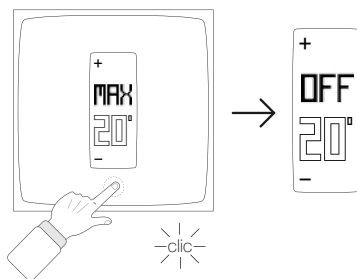

To use your Thermostat from your smartphone, tablet or computer, visit:

<http://thermostat.netatmo.com>



PC / Mac



Smartphone / Tablettes

# Specifications

## SIZE

Thermostat: 83 x 83 x 22 mm

## DESIGN

Designed by Starck.

Translucent minimalist plexiglass cube.  
5 interchangeable colours in the box.

## SENSORS AND MEASUREMENTS

Temperature (measurement):

Ranges from : 0°C à 50°C

Accuracy: +/- 0,1°C

Temperature (setpoint):

Ranges from: 5°C à 30°C

Incément: 0.5°C

Unit: °C

## E-INK DISPLAY

Energy efficient, longer battery life and optimal readability.

## FREE APP, LIFETIME SUPPORT

No subscription fee.

App available on the App Store,

Windows Phone Store and on

Google Play.

Free access to your online personal dashboard.

Accessible from multiple devices.

## WIRELESS SPECIFICATIONS

Wi-Fi 802.11 b/g/n compatible (2.4GHz).

Supported security: Open/WEP/WPA/

WPA2-personal (TKIP and AES).

Wireless connection between thermostat and relay:  
radio long range 100 m.

## POWER AND BATTERIES

3 AAA batteries.

1 year battery life.

## SETUP AND COMPATIBILITY

Compatible with gas, fuel, wood boilers  
and heat pumps.

Switching current: max 4 A

Switching voltage: max 250 VAC

Switching power: max 120 W

## COMPATIBLE WITH IPHONE AND IPAD

iPhone 4, iPhone 4s, iPhone 5, iPhone 5c / 5s

iPhone 6, iPhone 6 Plus

iPad mini, iPad 2, iPad (3rd generation),

iPad (4th generation), iPad Air, iPad Air 2

iPod touch (5th generation)

## COMPATIBLE WITH ANDROID SMARTPHONE / WINDOWS PHONE

Android 4.0 minimum with access

Google Play

Windows Phone 8.0 minimum



## EU Declaration of Conformity

We, Netatmo, declare that this device is in compliance with the essential requirements and other relevant provisions of Directive 1999/5/EC.

### Safety warnings

This device must be installed according to the applicable norms. Use only with supplied power plug adaptor and boiler adaptor. This device is for indoor use only. Before inserting the batteries, check that the contacts in the device and on the batteries are clean, is necessary clean them. Note the polarity (+/-) when inserting the batteries. Do not throw the batteries into a fire, short-circuit them or dismantle them. Keep children away from batteries. Seek medical attention immediately if a battery is swallowed. Do not attempt to repair the device yourself; customer service is available. Any changes or modifications to this unit not expressly approved by the party responsible for

compliance could void the user's authority to operate the equipment. Thermostat and relay insulation: class II devices. This device is not intended for use by persons (including children) with reduced physical, sensory or mental capabilities, or lack of experience and knowledge, unless they have been given supervision or instruction concerning use of the appliance by a person responsible for their safety.

Children should be supervised to ensure that they do not play with the appliance.

### Legal notice

"Made for iPod", "Made for iPhone", "Made for iPad" mean that an electronic accessory has been designed to connect specifically to iPod, iPhone and iPad and has been certified by the developer to meet Apple performance standards. Apple is not responsible for the operation of this device or its compliance with safety and regulatory standards. Please note that the use of this accessory with iPhone may affect wireless performance.



<http://support.netatmo.com>

